



GEMÄLDEGALERIE

The Gemäldegalerie (Old Master Paintings) of the Staatliche Museen zu Berlin (National Museums in Berlin) owns one of the most important collections of European art from the beginnings of medieval panel painting of the 13th century up to the Neoclassicism of the period around 1800. The collection's colourful history began in 1830, when the gallery was installed in the Royal Museum building (today's Altes Museum) designed by Karl Friedrich Schinkel overlooking Berlin's Lustgarten. Works of art were chosen from the royal palaces, and certain private collections were purchased. Wilhelm von Bode, the gallery's most important director during the 19th and early 20th century, succeeded in steadily expanding the collection with the assistance of the Kaiser Friedrich Museumsverein. Thanks to this tradition of systematic collecting, the Gemäldegalerie is in a position to present the history of European painting in all its schools and epochs.



Sandro Botticelli:
Tondo Raczynski, around 1477

Michelangelo Merisi da Caravaggio:
Amor Victorious, 1601/02

Albrecht Dürer:
Hieronymus Holzschuher, 1526

Giovanni Antonio Canal
(aka Canaletto): Santa Maria della
Salute in Venice, seen from the Grand
Canal, before 1730

Rembrandt Harmensz van Rijn:
Self-portrait with velvet beret and a
coat with fur collar, 1634

Jan Vermeer van Delft: Young Woman
with a Pearl Necklace, around 1662/65

After being split up for many years, the collection was reunited in 1998 in a new gallery building at the Kulturforum. The permanent exhibition shows about 1500 works out of the total of about 3000 in the collection. Particularly worthy of note are the early Italian painting section, with works by Giotto, Fra Angelico, and Botticelli, and the collection of Early Netherlandish Masters with paintings by Jan van Eyck, Rogier van der Weyden, and Hugo van der Goes. As a counter-piece to this the collection of German Old Masters includes works by Albrecht Dürer and Hans Holbein. The Rembrandt collection in the Gemäldegalerie is among the world's largest and most exquisite. The art of the European Baroque period ranges from Caravaggio and the Roman 17th century via Peter Paul Rubens to Diego Velázquez, whilst our French collection includes wonderful masterpieces by Nicolas Poussin and Antoine Watteau.

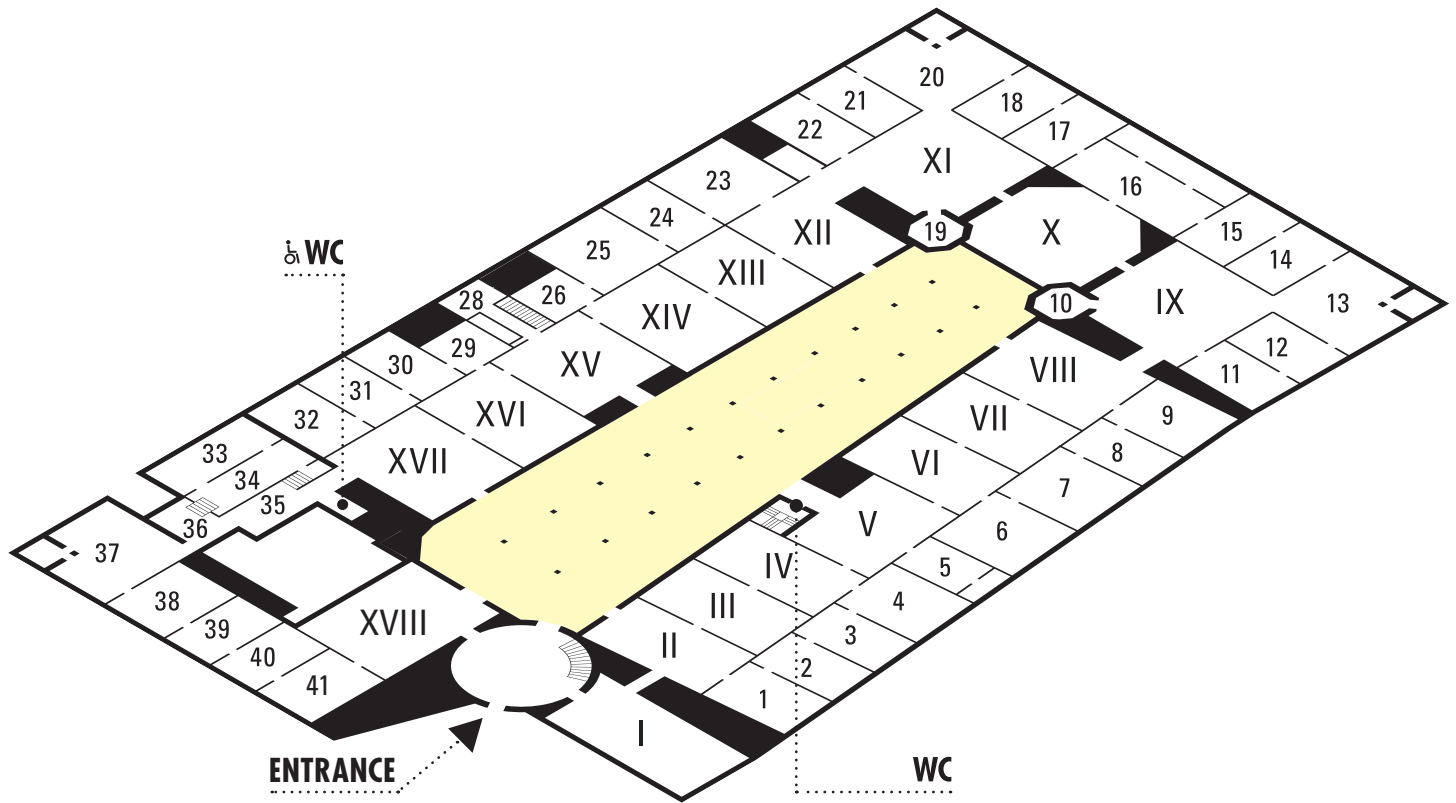

- | | | | |
|-------------|---|-----------|--|
| I – III | | XV – XVII | |
| 1 – 4 | German Painting
Dürer, Cranach, Altdorfer | 29 – 32 | Italian Painting
Raphael, Titian, Correggio |
| 5 | Exhibitions of the Kupferstichkabinett
(Museum of Prints and Drawings) | 33 | “Kinder-Reich” (“Children’s Realm”):
the Painter’s Workshop |
| IV – VI | | 34 | Miniature Painting |
| 4 – 7 | Netherlandish Painting
Van Eyck, Bruegel, Bosch | XVIII | |
| VII – XI | | 35 – 41 | Italian Painting
Giotto, Mantegna, Botticelli |
| 8 – 19 | Flemish and Dutch Painting
Rubens, Rembrandt, Vermeer | | |
| 20 – 22 | English, French, and German Painting
Gainsborough, Watteau, Boucher | | |
| XII – XIV | | | |
| 23 – 26, 28 | Italian, French, and Spanish Painting
Caravaggio, Velázquez, Poussin | | |
- Central hall/special exhibitions

Gemäldegalerie

Staatliche Museen zu Berlin
Kulturforum

Matthäikirchplatz 6
10785 Berlin

Tuesday – Friday 10 am – 6 pm
Thursday 10 am – 8 pm
Saturday – Sunday 11 am – 6 pm

Audio guides in several languages
are included in the ticket price.
Without waiting in all museums
and exhibitions:
www.smb.museum/tickets

Information, assistance, reservations

Monday – Friday 9 am – 4 pm
Tel.: +49 (0)30 – 266 42 42 42
Fax: +49 (0)30 – 266 42 22 90
service@smb.museum
www.smb.museum/gg

Events

www.smb.museum/veranstaltungen

Subject to changes