



Jean-Baptiste S. Chardin
The Draftsman



Caravaggio
Cupid as Victor



Sandro Botticelli
The Virgin and Child with Singing Angels



Tizian
Clarissa Strozzi at the age of two

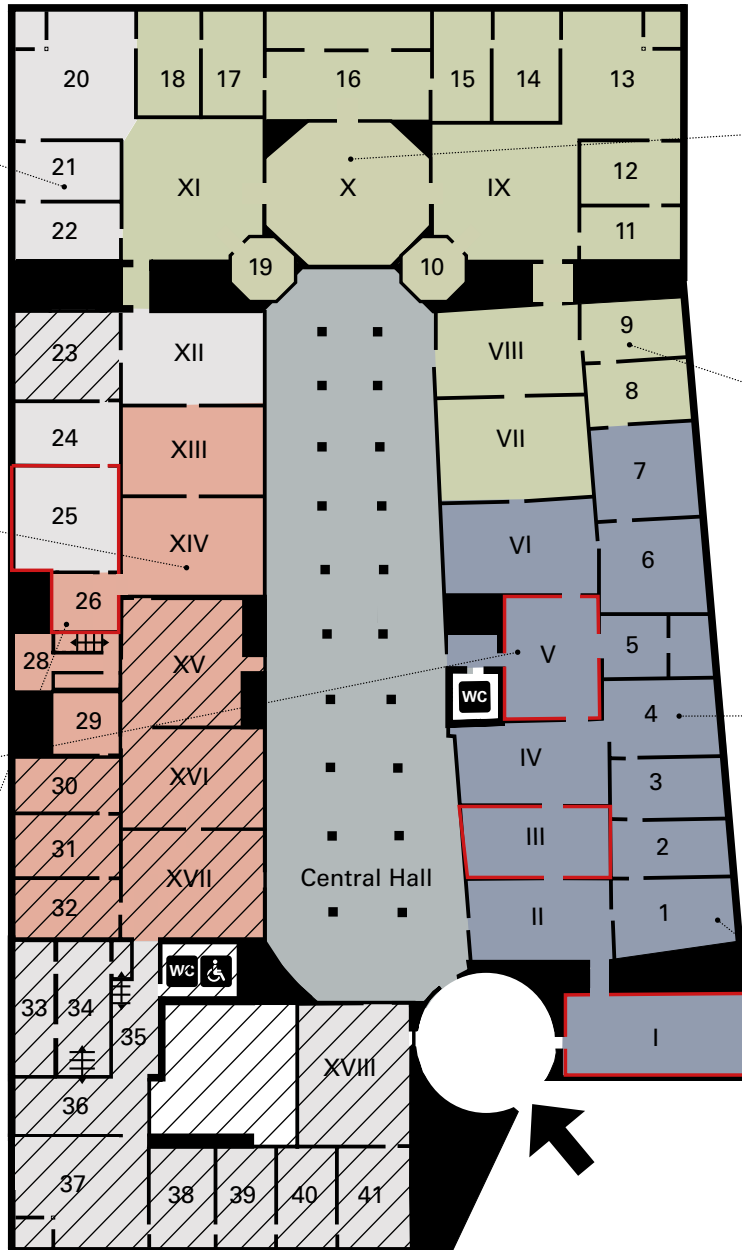

Rembrandt
Self-Portrait with Velvet Beret



Peter Paul Rubens
Child with a Bird



Petrus Christus
Portrait of a Young Woman



Hans Holbein
The Merchant Gisze

- | | | | |
|---|--|--|---|
| <ul style="list-style-type: none"> Cabinet I, III, V Hall I – VI
Cabinet 1 – 7 Cabinet 5 Hall VII– XI
Cabinet 8 – 19 Cabinet 20 – 22 Cabinet 23 | <ul style="list-style-type: none"> Dialogues with Old Dutch and Old German painting German and Netherlandish painting of the 13th to 16th century Exhibition of the Kupferstichkabinett (Museum of Prints and Drawings) Flemish and Dutch painting of the 17th century English, French and German painting of the 18th century <i>Closed temporarily</i> | <ul style="list-style-type: none"> Cabinet 25 – 26 Hall XII – XIV
Cabinet 24 – 26, 28 Hall XV – XVII
Cabinet 29 – 32 Cabinet 33
Cabinet 34 Hall XVIII
Cabinet 35 – 41 Central Hall | <ul style="list-style-type: none"> Highlights from the closed exhibition rooms Italian, French and Spanish painting of the 17th to 18th centuries Italian painting of the 16th century
<i>Closed temporarily</i> Children’s Realm: the painter’s workshop
Miniature painting
<i>Closed temporarily</i> Italian painting of the 13th to 15th centuries.
<i>Closed temporarily</i> Special exhibition |
|---|--|--|---|

WELCOME TO THE GEMÄLDEGALERIE

The Gemäldegalerie (Old Master Paintings) of the Staatliche Museen zu Berlin (National Museums in Berlin) holds one of the most important collections of European art, ranging from the beginning of medieval panel painting in the 13th century through to the Neoclassicism of the period around 1800. This collection makes it possible to study the history of European painting in all its schools and epochs.

Since its opening in 1830 the collection has had an eventful history. Today, some 1,300 paintings are exhibited in the gallery at the Kulturforum. The focus of the collection lies on Italian art of the 13th to 17th centuries, with works by the great Italians Giotto, Botticelli, Raphael, Titian and Caravaggio, as well as the early German masters, with paintings by Konrad Witz, Albrecht Dürer, Lucas Cranach and Hans Holbein.

One of the highlights is the world's most important collection of Netherlandish art from the 15th and 16th centuries. It includes masterpieces by Jan van Eyck, Rogier van der Weyden, Hugo van der Goes and Pieter Bruegel. The holdings of the Dutch and Flemish masters of the 17th century are also outstanding. In addition to one of the largest Rembrandt collections in the world, the Gemäldegalerie holds masterpieces by Vermeer, Rubens, Anton van Dyck, Frans Hals and Jan van Goyen.

The splendid collection of Italian, French, German and English paintings of the 18th century includes works by Canaletto, Jean-Antoine Watteau, Antoine Pesne and Thomas Gainsborough.

Collection online

- Exhibitions and events:
www.smb.museum/gg-en
- Artworks: www.smb-digital.de
- You can't find one of the paintings?
The most important works currently out on loan:
www.smb.museum/gg-on-tour

 /gemaeldegalerie

 @gemaeldegalerie

 Museum Free WiFi

Opening hours

Tue–Sun: 10 am–6 pm
Thu: 10 am–8 pm
Closed on Mondays

Kulturforum
Matthäikirchplatz
10785 Berlin

Audio guides

Included in the ticket price
Languages: German, English, French, Italian

Guided tours

Information and booking:
Tel. +49 30 266 42 42 42
(Mon–Fri, 9 am–4 pm)
service@smb.museum

Information for visiting the museum

Please:

- do not touch the artworks
- take photos only without flash
- do not make phone calls within the exhibition spaces
- use (lead or coloured) pencils only

Buchhandlung Walther König

Catalogues, books, art postcards and gifts

Become a member

As a member of the Kaiser Friedrich Museumsverein (KFMV) you can support the Gemäldegalerie and take part in an exclusive events programme including guided tours, lectures, and art trips. Continue the tradition of the association founded in 1897, which enriches the collection primarily through significant acquisitions.

www.kaiser-friedrich-museumsverein.de